

Bridge

Tripod turnstile

Total safety, reduced dimensions.

Bridge, the sharp and silent turnstile is ideal for controlling entrances and exits in small and medium sized sports centres, supermarkets and businesses. By taking up little room it works perfectly even when space is a problem, and so is suited for multiple access control.



Colour:
Legs and cover in metallic grey, textured white case, and stainless steel rods.



Electronics and lock.
The top cover, which is fitted with a key lock, can also take electronic control devices.



Proximity sensor.
When placing the order, the customer can request that the Bridge turnstile is supplied prepared for fitting the Came proximity sensor.



Advantages of Bridge

It comes in three different models, all fitted with hydraulic brakes, and easily fits into any setting. Its careful styling in terms of aesthetics, shape and rounded corners, make it stand out from the rest. Its galvanised, sheet metal body make Bridge a particularly sturdy product to resist vandalism and tampering; its special, epoxy powder varnish-coating protects it from environmental agents.

Dimensions

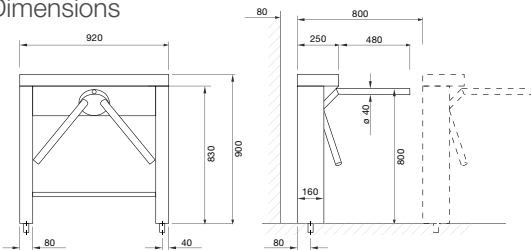

Dimensions in millimeters (25,4 mm = 1 in)

Technical features

Type	PSAP01A	PSAP01O	PSAP07
Power supply (V) (50/60Hz)	-	-	24V A.C.
Protection rating (IP)	44	44	44
Current draw (mA)	-	-	233
Weight (Kg/lb)	40 / 88	40 / 88	40 / 88
Operating temperature (°C/°F)	-20 ÷ +55 / -4 ÷ +131	-20 ÷ +55 / -4 ÷ +131	-20 ÷ +55 / -4 ÷ +131

120V A.C. - 60 Hz PRODUCTS, PLEASE CHECK OUR PRICE LIST

24V D.C.



The complete range

Mechanical tripod turnstile

- Parking systems and access control price list -

- 001PSAP01A Monodirectional mechanical anticlockwise turnstile complete with hydraulic damper. Painted steel structure.
- 001PSAP01O Monodirectional mechanical clockwise turnstile complete with hydraulic damper. Painted steel structure.

Electromechanical tripod turnstile

- 001PSAP07 24V D.C. electromechanical, bidirectional turnstile complete with control board and hydraulic damper. Automatic tripod release during blackouts.

Additional accessories for mechanical and electromechanical tripod turnstiles.

- 001PSOPSC01 Antipanic rods with pressure joints.
- 001PSOPCN01 Mechanical counter.

- 001PSOPG01 AISI 304 steel channeler - H 100cm complete with metal flange riser and plastic flange cover.
- 001PSOPG01X AISI 304 steel channeler - H 100 cm complete with metal flange riser and plastic flange cover.

Additional accessories for electromechanical tripod turnstiles.

- 001PSCSCR04 Remote control console for up to 4 through-ways.
- 001PSOPCN03 Electronic counter

- 001PSOPSCA Overclimbing system with detection sensors and alarm and cover pressure detection sensor.

- 001PSOPSF01 High visibility, bidirectional LED traffic light.

- 001PSPEART Ramp with anti-corodal outer structure and brown aluminium plate stepping deck. For matching to Top barriers.

NOTES:

To couple with access control systems see RBM84 on p. 208

24V only

Its 24V power rating makes for easier installation and also guarantees enhanced safety for users.